

# HSP

Recommended Pads Layout(Top View)  
 Note:Tolerance For PCB Layout is  $\pm 0.05$

Notes:  
 Rated Current:3.0AMP  
 Contact Resistance: $25m\Omega$  max  
 Withstand Voltage:1000V AC/Minute  
 Insulation Resistance: $50000M\Omega$  min at DC 500V  
 Operation Temperature: $-55^{\circ}C$  to  $+105^{\circ}C$

Contact Material: Brass  
 Contact Plating: Au or Sn Over Ni  
 Insulator Material: PBT+30%(UL94V-0)  
 Shell: Steel, Ni Plated

Mechanical Characteristics:  
 Contact Insertion Force: 300gf Max.  
 Contact Separation Force: 25gf Min.

## Ordering Information

**BT6223 \*\* F \* B A 4 B47**

NO. OF PINS 09,15,25,37P  
 CONTACT PLATING  
 F=Gold Flash/Tin  
 A=10 $\mu$ 'Gold/Tin  
 J=15 $\mu$ 'Gold/Tin  
 K=30 $\mu$ 'Gold/Tin  
 S=Tin Plated  
 U=Gold Flash  
 X=10 $\mu$ 'Gold  
 W=15 $\mu$ 'Gold  
 Y=20 $\mu$ 'Gold  
 Z=30 $\mu$ 'Gold  
 INSULATOR COLOR  
 B=Black  
 W=White  
 U=Blue  
 G=Grey  
 Insulation & Packing  
 A: PBT+Troy  
 B: PBT+Tube  
 D: PBT+PE Bag  
 I: PABT+Troy  
 J: PABT+Tube  
 SERIES NO.

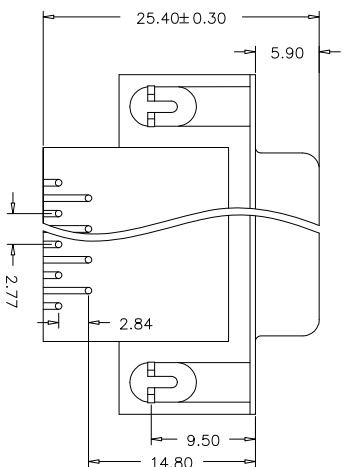
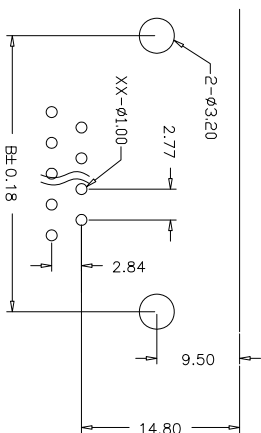
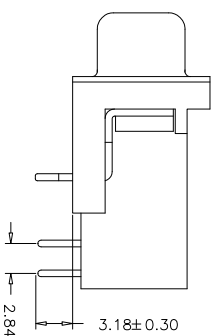
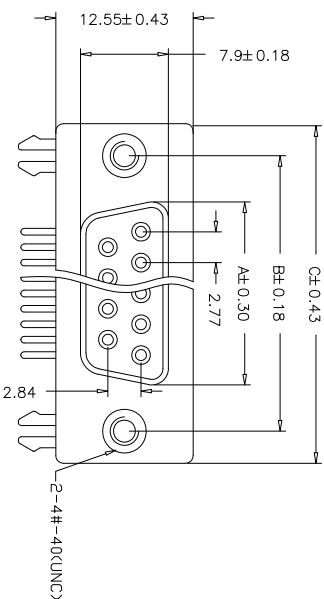

No.	Dimension	
	Min	Max
9	$16.33$	$30.85$
15	$24.99$	$39.14$
25	$38.38$	$53.04$
37	$54.84$	$69.32$

REV	DATE	MODIFICATION DESCRIPTION	CHANGE	APPROVE	OPERATION	DRAW	HEMING	SCALE	SHEET	PART NO.	TITLE:
A0	09/02/18	NEW			XX XXX X XXX	DESIGN CHECK	09/02/18	mm A4	1/1	BT6223**F*BA4B47	D-Sub Female connector 14.80mm Footprint R/A Type



BMA TECHNOLOGIES LTD