

# HSPF

**NOTES:**

- Rated Current: 5.0AC,DC.
- Withstand Voltage: 1000V AC/minute.
- Insulation Resistance: 1000M\U+2126 min.
- Operation Temperature: -25℃ to +85℃.
- Contact Material: Brass.
- Plating: Gold Flash on Contact Area 100u”
- min. Tin/Lead Plated on Soldering end
- Over 50u” min. Nickel under-Plating.
- Shell Material: Steel, Nickel/Tin Plated.
- Insulator Material: PBT+25% Glass Fiber (UL94V-0).

## Ordering Information

BT6212 XX M X X A 1 B09

No.of pins  
15,26,44,62

M=Male

Contact Plating  
F=Gold Flash/Tin  
A=10u”Gold/Tin  
J=15u”Gold/Tin  
K=30u”Gold/Tin  
S=Tin Plated

Packing  
B=Black  
U=Blue

Material & Packing  
A=PBT+Tray  
D=PBT+PE Bag

Contact Shape  
I=Straight  
Without Screwlock  
Without Boardlock

S=Tin Plated

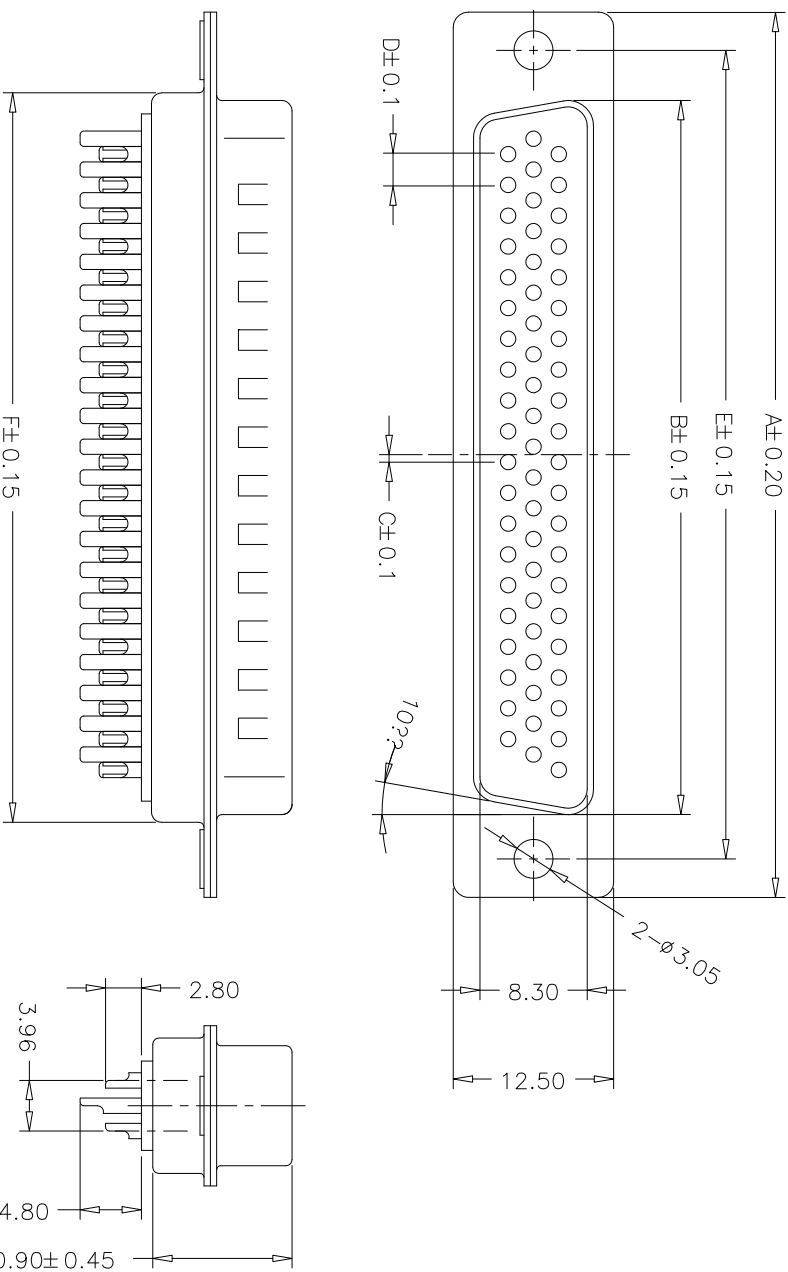

No.of Positions	DIM "A"	DIM "B"	DIM "C"	DIM "D"	DIM "E"	DIM "F"
15	30.80	16.92	0.25	2.29	24.99	19.30
26	39.20	25.25	0.51	2.29	33.32	27.30
44	53.10	38.96	0.51	2.29	47.04	41.30
62	69.30	55.40	0.58	2.41	63.50	57.30

REV	DATE	MODIFICATION DESCRIPTION	CHANGE	APPROVE	OPERATION	DRAW	SCALE	PART NO.	TITLE:
A0	09/02/19	NEW			XX ±0.40	Fanyijun	mm	BT6212XXMXXA1B09	HDB Male Connector, Solder Type
					XXX ±0.25	DESIGN	A4		
					XXX ±0.15	CHECK	1/1		
					Angle ± 3'	APPROVE			
					DIM TOL				

