

**NOTES:**

- Electrical Specification:  
Current Rating: 1.5AMP(AC/DC)  
Contact Resistance: 30mΩ max  
Voltage Rating: 30V AC/DC  
Withstand Voltage: 500V AC/DC For 1Minute  
Insulation Resistance: 100MΩ min  
Operation Temperature: -35°C to +85°C
- Material:  
Contact: Phosphor Bronze.  
Peg: Brass, Tin Plated.  
Contact plating: Sn or Au Over Ni  
Insulator:  
Plastic parts: VECTRA(LCP) or High Temperature Plastic (UL94V-0)  
Color: Black.

## Ordering Information

BT5411 22 X X 2 1 B20

- |             |                       |                  |          |
|-------------|-----------------------|------------------|----------|
| No. of Pins | CONTACT SHAPE         | Contact Plating  | Packing  |
| 7+15        | 1: 180°SMT Up Contact | U=Gold Flash     | (=PE Bag |
|             | 2: 90°SMT Up Contact  | X=10u"Gold       | 1=Tray   |
|             | 3: 180°DIP Up Contact | W=15u"Gold       | 2=Tube   |
|             | 4: 90°DIP Up Contact  | Y=20u"Gold       |          |
|             |                       | Z=30u"Gold       |          |
|             |                       | F=Gold Flash/Tin |          |
|             |                       | A=10u"Gold/Tin   |          |
|             |                       | J=15u"Gold/Tin   |          |
|             |                       | K=30u"Gold/Tin   |          |
|             |                       | S=Tin Plated     |          |

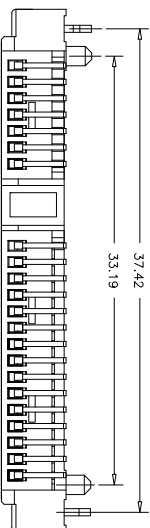
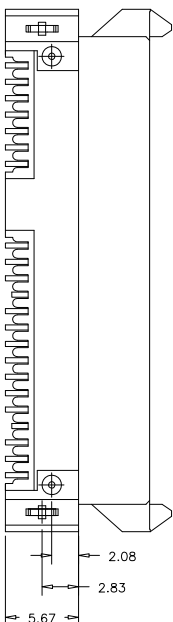
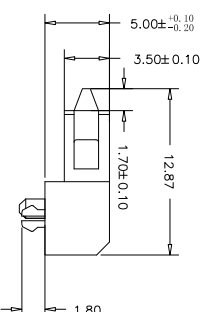
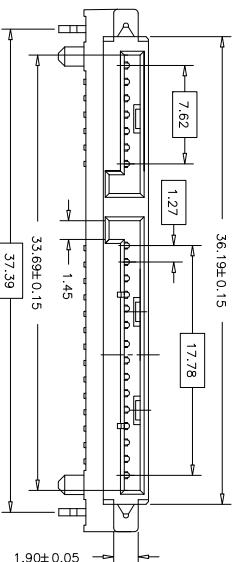
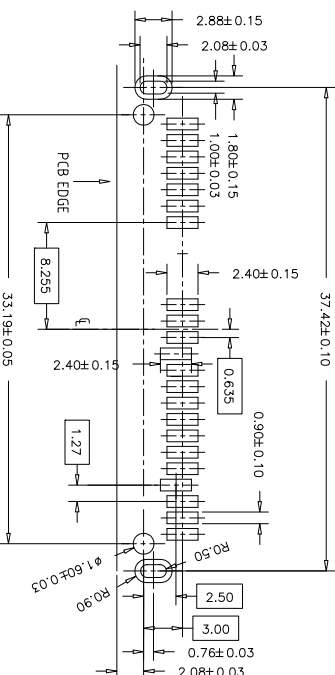
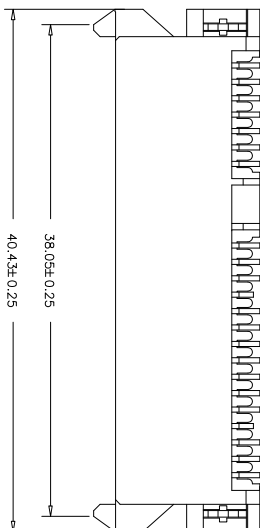

REV	DATE	MODIFICATION DESCRIPTION	CHANGE	APPROVE	OPERATION	DRAW	Bill	09/01/19	SCALE	UNIT	SIZE	SHEET	PART NO.	TITLE:
A0	09/01/19	NEW			XX ±0.40	DESIGN			-	mm	A4	1/1	BT5411222X21B20	SATA 7+15P Female SMT 90°
					X XXX ±0.25	CHECK								
					Angle ± 3									
					DIM	APPROVE								
1	2	3	4	5	6	7	8	9	10					

