

# HSP

## Specifications

- Applicable Wire: 22AWG-28AWG.
- Material: Phosphor Bronze.
- Finish: Tin Plated.

# Ordering Information

## BT2505 T P \* 01 A19

Material:  
P:Phosphor Bronze  
B:Brass

Contact Plated  
S=Tin Plated  
N=Nickel Plated

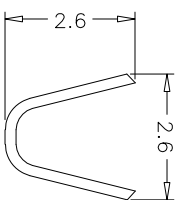
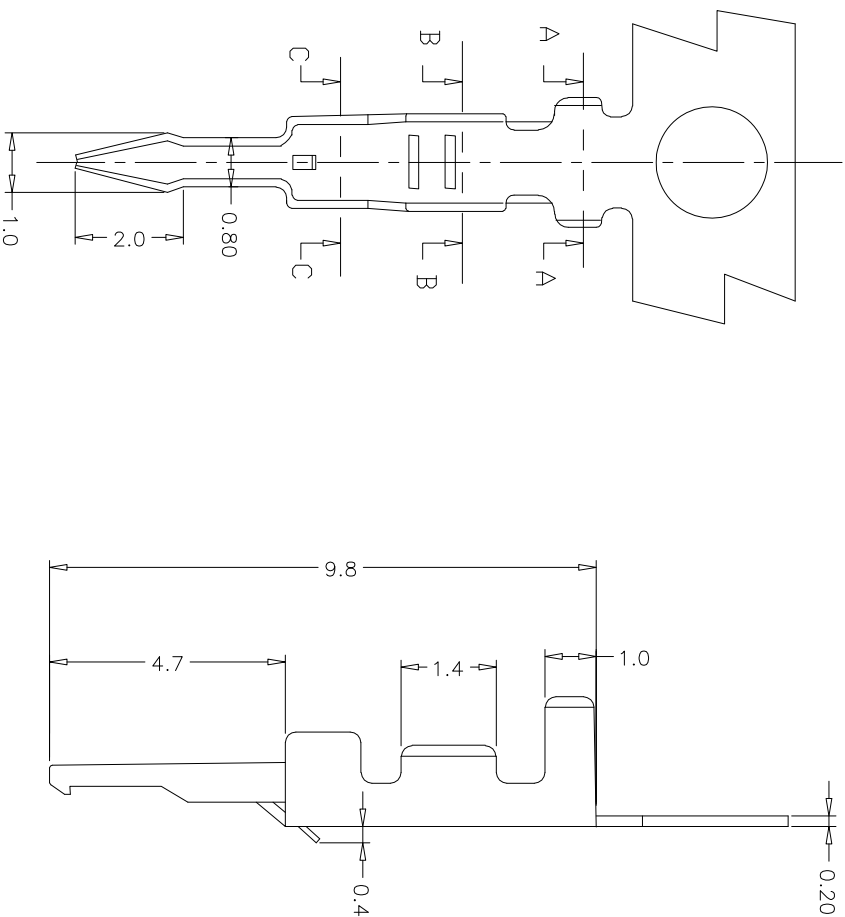

Sections A-A

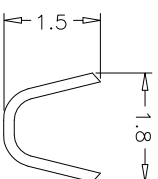

Sections B-B

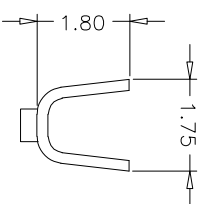

Sections C-C

REV	DATE	MODIFICATION DESCRIPTION	CHANGE	APPROVE	OPERATION		DRAW	Heming	09/01/19	SCALE		PART NO.	TITLE:	SCN2.50 Pitch Terminal
					XX	±0.40				UNIT	—			
					XXX	±0.25	DESIGN			mm				
					XXX	±0.15	CHECK	Fanyijun		A4				
A0	09/01/19	NEW			Angle	±.3	APPROVE	Bill		1/1		BT2505TP*01A19		
					DIM	TOL								

