

NOTES:

- Rated Current: 2.0AMP AC,DC
- Rated Voltage: 250V AC,DC
- Insulation Resistance: 500M\U+2126 min
- Withstanding Voltage: 1000V AC/Minute
- Operation Temperature: -25°C to +85°C
- Insulator Material: Nylon66,UL94V-0

Color: Beige

Ordering Information

BT2502 H ** E 01 A28

No.Of Pins
02-20Pin

Colour
E=Beige
W=White

Packing
01PE Bag
1:Tray
2:Tube
3:1 Tape&Reel

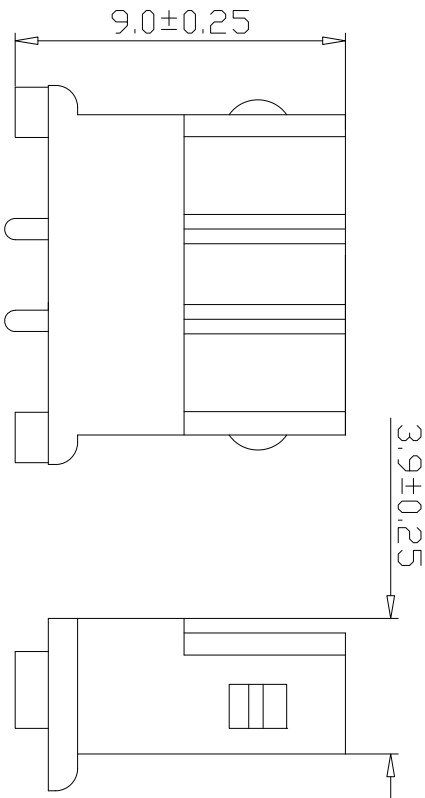
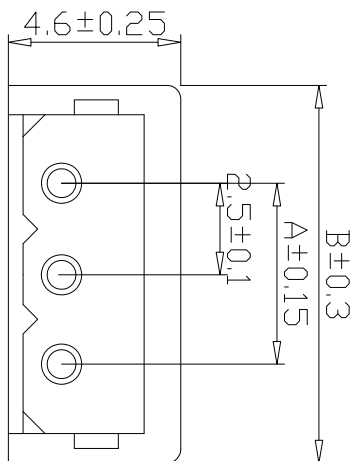

PART NID.	Dimensions	
	A	B
BT2502H02E01A28	2.5	7.5
BT2502H03E01A28	5.0	10.0
BT2502H04E01A28	7.5	12.5
BT2502H05E01A28	10.0	15.0
BT2502H06E01A28	12.5	17.5
BT2502H07E01A28	15.0	20.0
BT2502H08E01A28	17.5	22.5
BT2502H09E01A28	20.0	25.0
BT2502H10E01A28	22.5	27.5
BT2502H11E01A28	25.0	30.0
BT2502H12E01A28	27.5	32.5
BT2502H13E01A28	30.0	35.0
BT2502H14E01A28	32.5	37.5
BT2502H15E01A28	35.0	40.0
BT2502H16E01A28	37.5	42.5
BT2502H17E01A28	40.0	45.0
BT2502H18E01A28	42.5	47.5
BT2502H19E01A28	45.0	50.0
BT2502H20E01A28	47.5	52.5

REV	DATE	MODIFICATION DESCRIPTION	CHANGE	APPROVE	OPERATION	DRAW	heating	09/01/19	SCALE	SHEET	PART NO.
A0	09/01/19	NEW			XX ±0.40	DESIGN			mm	1/1	BT2502H**E01A28
					XXX ±0.25	CHECK			A4		
					Angle ± 3'						
					DM						



2.50mm Pitch Housing