

Specifications

- Current Rating: 1.5A
 - Contact Resistance: 20mΩ Max
 - Withstand Voltage: 500V AC
 - Insulation Resistance: 1000MΩ Min
 - Operation Temperature: -40°C ~ +105°C
- Material:**
- Contact Material: Phosphor Bronze
 - Contact Plating: Gold Flash Or Tin Plated
 - Insulator Material: Polyester (UL94V-0)
 - Standard: PA6T

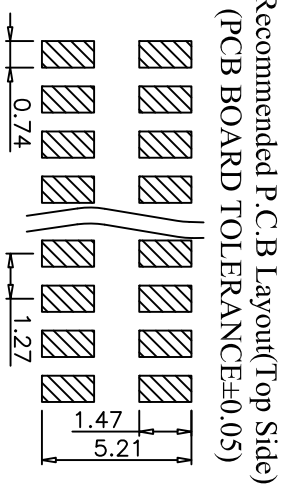
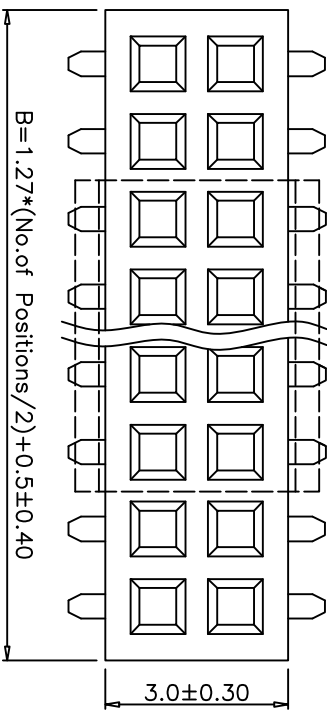

Ordering Information

BT2320 2 ** * 3 A03

- 2=Dual Row
- No. of Pins 02=2Pin
- Contact Plating U=Gold Flash S=Tin Plated X=0u" Gold
- Packing K=P A6T+1tape&Reel J=P A6T+Tube
- Contact Shape 3: SMT

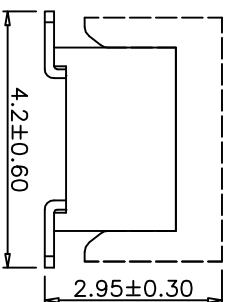
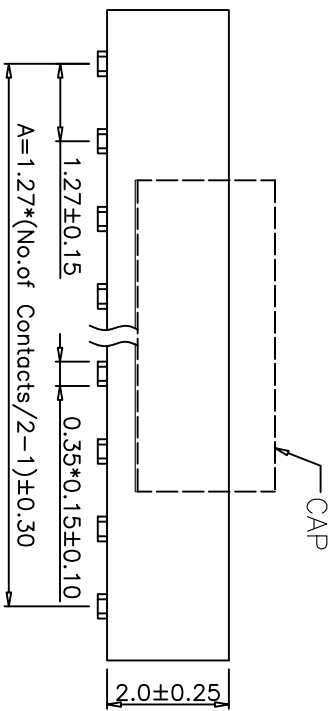

REV	DATE	MODIFICATION DESCRIPTION	CHANGE	APPROVE	OPERATION		DRAW	QIuzhi rong	09/04/20	SCALE	UNIT		SHEET	1/1	PART NO.	BT23202*** 3A03
					Angle	DIM					± °'	TOL				
A0	09/04/20	NEW			X.X	±0.40	DESIGN			-	mm	A4				
					X.XX	±0.25	CHECK	Shine								



PART NO. BT23202*** 3A03
FH1.27*2.0 Dual Row SMT W:4.2mm

Specifications

- Current Rating: 1.5A
 - Contact Resistance: 20mΩ Max
 - Withstand Voltage: 500V AC
 - Insulation Resistance: 1000MΩ Min
 - Operation Temperature: -40°C ~ +105°C
- Material:
- Contact Material: Phosphor Bronze
 - Contact Plating: Gold Flash Or Tin Plated
 - Insulator Material: Polyester (UL94V-0)
 - Standard: PA6T

Ordering Information

BT2320 2 ** * 4 A03

2=Dual Row
 No.of Pins 02=2Pin
 Contact Plating U=Gold Flash
 S=Tin Plated
 X=10u" Gold
 Packing K=P A6T+1 Tape&Reel
 J=P A6T+1 Tube
 9S=8Pin
 AI=100Pin

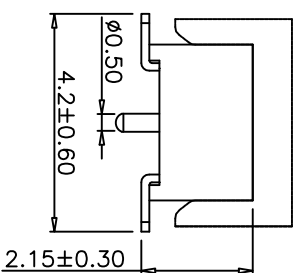
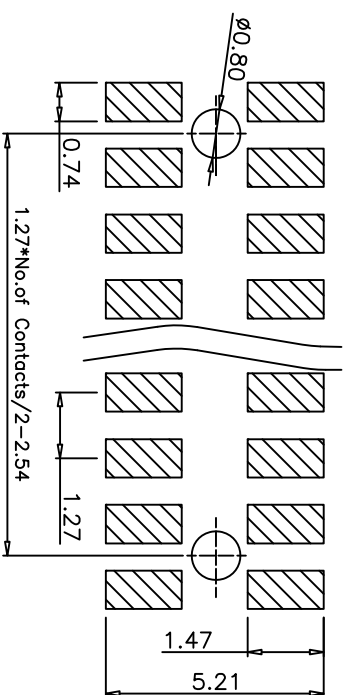
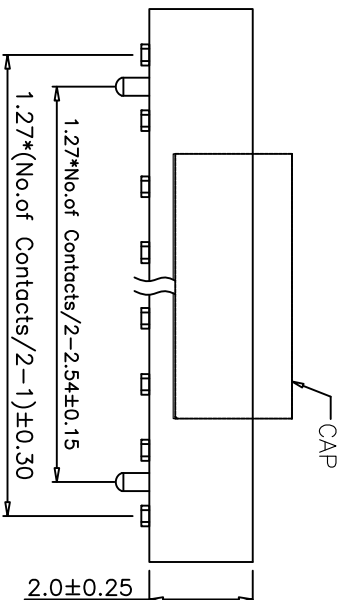
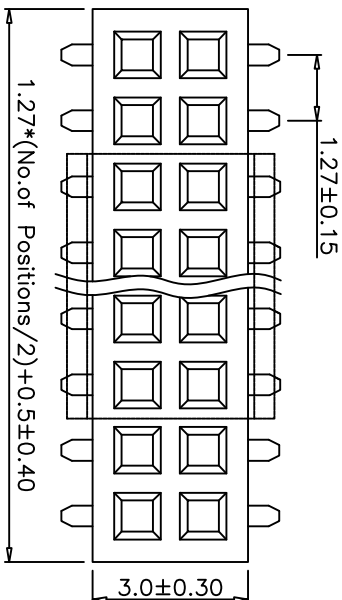

Recommended P.C.B Layout(Top Side)
 (PCB BOARD TOLERANCE±0.05)

REV	DATE	MODIFICATION DESCRIPTION	CHANGE	APPROVE	OPERATION	DRAW	SCALE	TITLE:																				
A0	09/05/20	NEW			<table border="1"> <tr> <td>XX</td> <td>±0.40</td> <td>DESIGN</td> <td>UNIT</td> <td>mm</td> </tr> <tr> <td>XXX</td> <td>±0.25</td> <td>CHECK</td> <td>SIZE</td> <td>A4</td> </tr> <tr> <td>XXX</td> <td>±0.15</td> <td>Shine</td> <td>SHEET</td> <td>1/1</td> </tr> <tr> <td>Angle</td> <td>± 3'</td> <td>APPROVE</td> <td>PROJ.</td> <td></td> </tr> </table>	XX	±0.40	DESIGN	UNIT	mm	XXX	±0.25	CHECK	SIZE	A4	XXX	±0.15	Shine	SHEET	1/1	Angle	± 3'	APPROVE	PROJ.		Qiuzhirong	09/05/20	BT23202****4A03
XX	±0.40	DESIGN	UNIT	mm																								
XXX	±0.25	CHECK	SIZE	A4																								
XXX	±0.15	Shine	SHEET	1/1																								
Angle	± 3'	APPROVE	PROJ.																									
1								FH1:27*2.0 Dual Row SMT W:4.2mm With Post																				

