

# HSP

- NOTES:
- Current rating: 3A,AC/DC
  - Voltage rating: 250V AC/DC
  - Contact Resistance: 20m $\Omega$ ? max
  - Withstand voltage: 1000V AC/minute
  - Insulation resistance: 1000M $\Omega$ ? min
  - Temperature range: -25 $^{\circ}$ C~+85 $^{\circ}$ C
  - Insulator Material: Nylon66 UL94V-0 or UL94V-2 Color: Black

## Ordering Information

BT2003 2H XX B 0 2 A02

No. of Row 2: Dual Row  
 No. Of Pins 02-50Pin  
 Colour B:Black  
 E:Beige  
 W:White  
 Packing 0:PE Bag  
 1: Tray  
 2: Tube  
 3: Tape&Reel

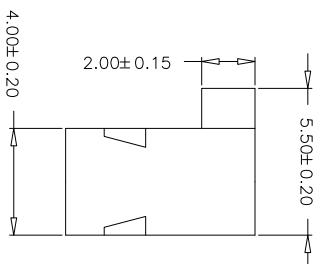
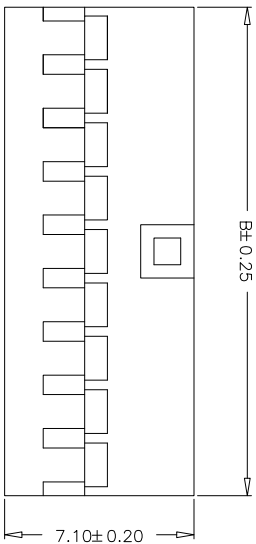
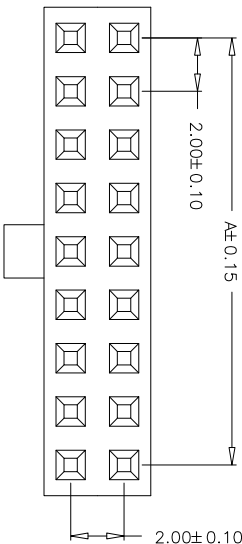

Dimensional & Ordering Information

| Circuit | Part No.      | Dimensions |       |
|---------|---------------|------------|-------|
|         |               | A          | B     |
| 2*1     | BT20032H02802 | --         | 2.30  |
| 2*2     | BT20032H04802 | 2.00       | 4.30  |
| 2*3     | BT20032H06802 | 4.00       | 6.30  |
| 2*4     | BT20032H08802 | 6.00       | 8.30  |
| 2*5     | BT20032H10802 | 8.00       | 10.30 |
| 2*6     | BT20032H12802 | 10.00      | 12.30 |
| 2*7     | BT20032H14802 | 12.00      | 14.30 |
| 2*8     | BT20032H16802 | 14.00      | 16.30 |
| 2*9     | BT20032H18802 | 16.00      | 18.30 |
| 2*10    | BT20032H20802 | 18.00      | 20.30 |
| 2*11    | BT20032H22802 | 20.00      | 22.30 |
| 2*12    | BT20032H24802 | 22.00      | 24.30 |
| 2*13    | BT20032H26802 | 24.00      | 26.30 |
| 2*14    | BT20032H28802 | 26.00      | 28.30 |
| 2*15    | BT20032H30802 | 28.00      | 30.30 |
| 2*16    | BT20032H32802 | 30.00      | 32.30 |
| 2*17    | BT20032H34802 | 32.00      | 34.30 |
| 2*18    | BT20032H36802 | 34.00      | 36.30 |
| 2*19    | BT20032H38802 | 36.00      | 38.30 |
| 2*20    | BT20032H40802 | 38.00      | 40.30 |
| 2*21    | BT20032H42802 | 40.00      | 42.30 |
| 2*22    | BT20032H44802 | 42.00      | 44.30 |
| 2*23    | BT20032H46802 | 44.00      | 46.30 |
| 2*24    | BT20032H48802 | 46.00      | 48.30 |
| 2*25    | BT20032H50802 | 48.00      | 50.30 |

| OPERATION | DRAW   | Zhangyalin | 09/01/06 | SCALE | UNIT | mm |
|-----------|--------|------------|----------|-------|------|----|
| XX        | DESIGN |            |          | 1/1   | A4   |    |
| X XX      | CHECK  |            |          |       |      |    |
| X XXX     |        |            |          |       |      |    |
| Angle     |        |            |          |       |      |    |
| ± 3'      |        |            |          |       |      |    |
| ± 0.15    |        |            |          |       |      |    |
| ± 0.40    |        |            |          |       |      |    |
| ± 0.25    |        |            |          |       |      |    |



BMA TECHNOLOGIES LTD

TECHNOLOGIES LTD

BT20032HXXB02A02

2.0Pitch Housing Dual Row W/Key

REV A0 09/01/12 DATE NEW MODIFICATION DESCRIPTION CHANGE APPROVE