

HSE

NOTES:

- Rated Current: 1.0A AC,DC
- Rated Voltage: 100V AC,DC
- Contact Resistance: 20mΩ max
- Insulation Resistance: 500MΩ min
- Withstanding Voltage: 500V AC/Minute
- Operation Temperature: -25°C to +85°C
- Insulator Material: Nylon66 UL94V-0
- Color: Natural(White)

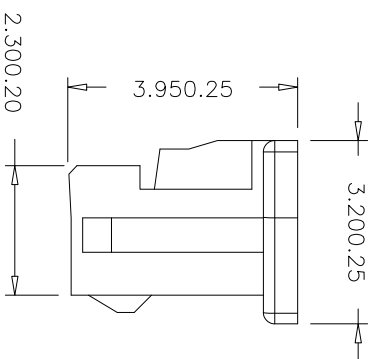
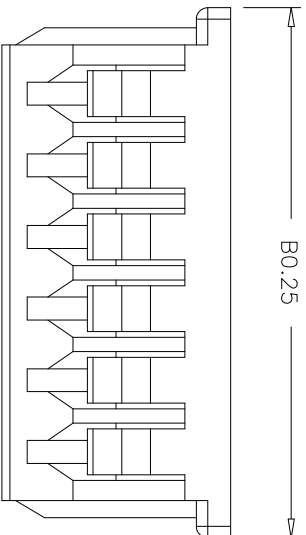
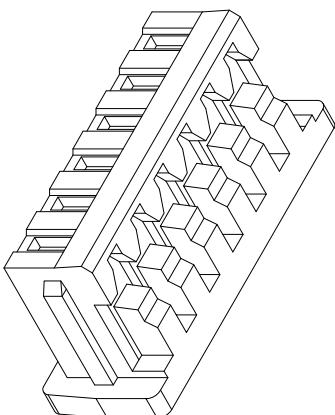
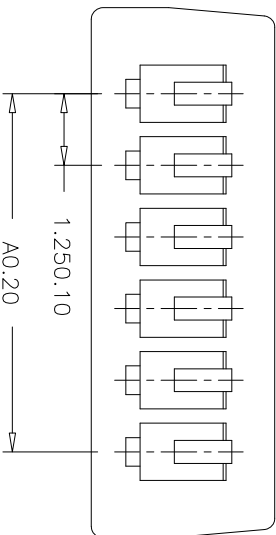

Ordering Information

BT1254 H * * W 01 A04

No. Of Pins
02~18Pin

Colour
E=Beige
W=White

Packing
O=PE Bag
A=Tray
T=Tube
R=Tap&Reel

REV	DATE	MODIFICATION DESCRIPTION	CHANGE	APPROVE	OPERATION	DRAW	heming	SCALE	SHEET	PART NO.	TITLE:	PROJ.	UNIT	SIZE	PITCH
A0	09/01/18	NEW			XX ±0.40	DESIGN		1/1	1/1	BT1254H**W01A04	MX1.25mm Pitch Housing	mm	A4		
					X,XXX ±0.15	CHECK									
					Angle ± 3'										
					DIM										
					TOL										

PART NO.	Dimensions	
	A	B
BT1254H02W01A04	1.25	4.25
BT1254H03W01A04	2.50	5.50
BT1254H04W01A04	3.75	6.75
BT1254H05W01A04	5.00	8.00
BT1254H06W01A04	6.25	9.25
BT1254H07W01A04	7.50	10.50
BT1254H08W01A04	8.75	11.75
BT1254H09W01A04	10.00	13.00
BT1254H10W01A04	11.25	14.25
BT1254H11W01A04	12.50	15.50
BT1254H12W01A04	13.75	16.75
BT1254H13W01A04	15.00	18.00
BT1254H14W01A04	16.25	19.25
BT1254H15W01A04	17.50	20.50
BT1254H16W01A04	18.75	21.75
BT1254H17W01A04	20.00	23.00
BT1254H18W01A04	21.25	24.25



BMA TECHNOLOGIES LTD