

Specification:

Current Rating :5.0 A AC/DC.
 Withstanding Voltage: 500V AC/DC.
 Insulation Resistance: 5000MΩ Min.
 Contact Resistance: 15mΩ Max.
 Operating Temperature:-55°C~+105°C.

Material:

Insulator:PBT (UL94V-0).

Contact: Brass.

Contact Plated : Gold or Tin over Nickel Plated.

Shell: Iron.

Color: Black .

Mechanical Characteristics:

Contact Insertion Force: 3.57 Kgf Max.

Contact Separation Force: 1.02 Kgf Min.

Ordering Information

BT DVIC 19 M * B * 1 B21

DVI Type 18+1Pin M:Male Contact Plating Color Insulation&Packing
 F:Gold Flash/Tin B:Black A: PBT Tray
 J:15μGold/Tin R: PBT Tube
 K:30μGold/Tin D:PBT,PE Bag

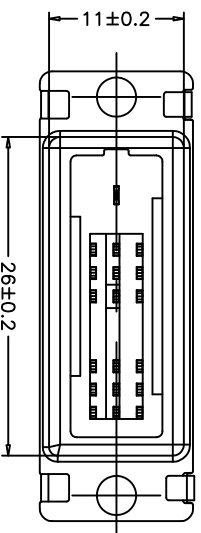
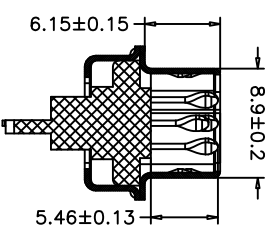
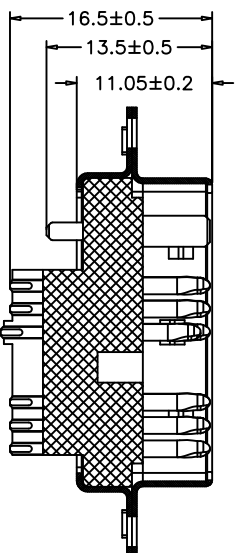
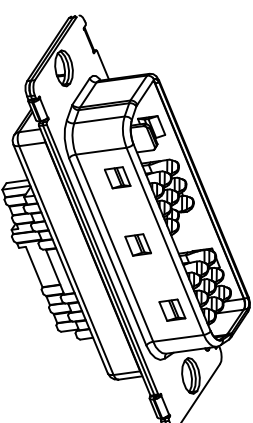
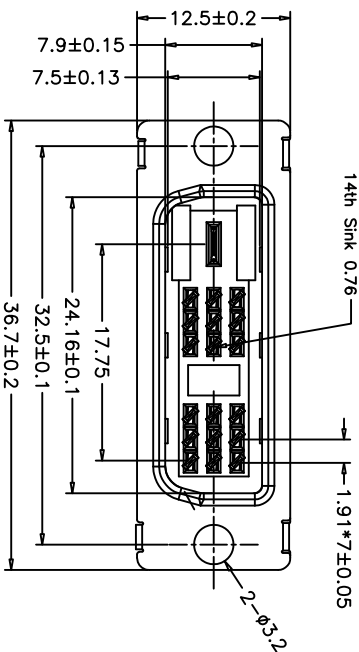

OPERATION	XX	±0.25	DRAW	Zhangyali lin	09/01/18	SCALE	-
	XXX	±0.15		DESIGN			
ANGLE	XXX	±0.05	CHECK	Shine	PROJ.	1/1	PART NO.
	Angle	± 5'		APPROVE		CK	
REV	DATE	MODIFICATION DESCRIPTION	CHANGE	APPROVE	DIM	TOL	DVI-D Single Link Solder Type 18+1Pin Connect
A0	09/01/18	NEW					BTDVIC19M*B*1B21

